

PRODUCT CATALOG

SOLUTIONS IN DIAMOND TOOLS
AND ACCESSORIES FOR
MACHINING PROCESSES OF

SOLID WOOD, PANELS AND
OTHER RAW MATERIALS



WIRUTEX
BRAZIL

Welcome to the new **Product Catalog of Wirutex Brazil**

In the following pages, you will get to know the main products and services we offer to our customers, as well as best practices for maintaining diamond tools and many other possibilities we can develop to improve your processes through our special projects.

SUMMARY

Panel Saw.....	04
CNC Machining Center.....	07
Clamping System.....	19
Edge Banding Machine.....	26
Special Projects.....	31
Sharpening.....	33

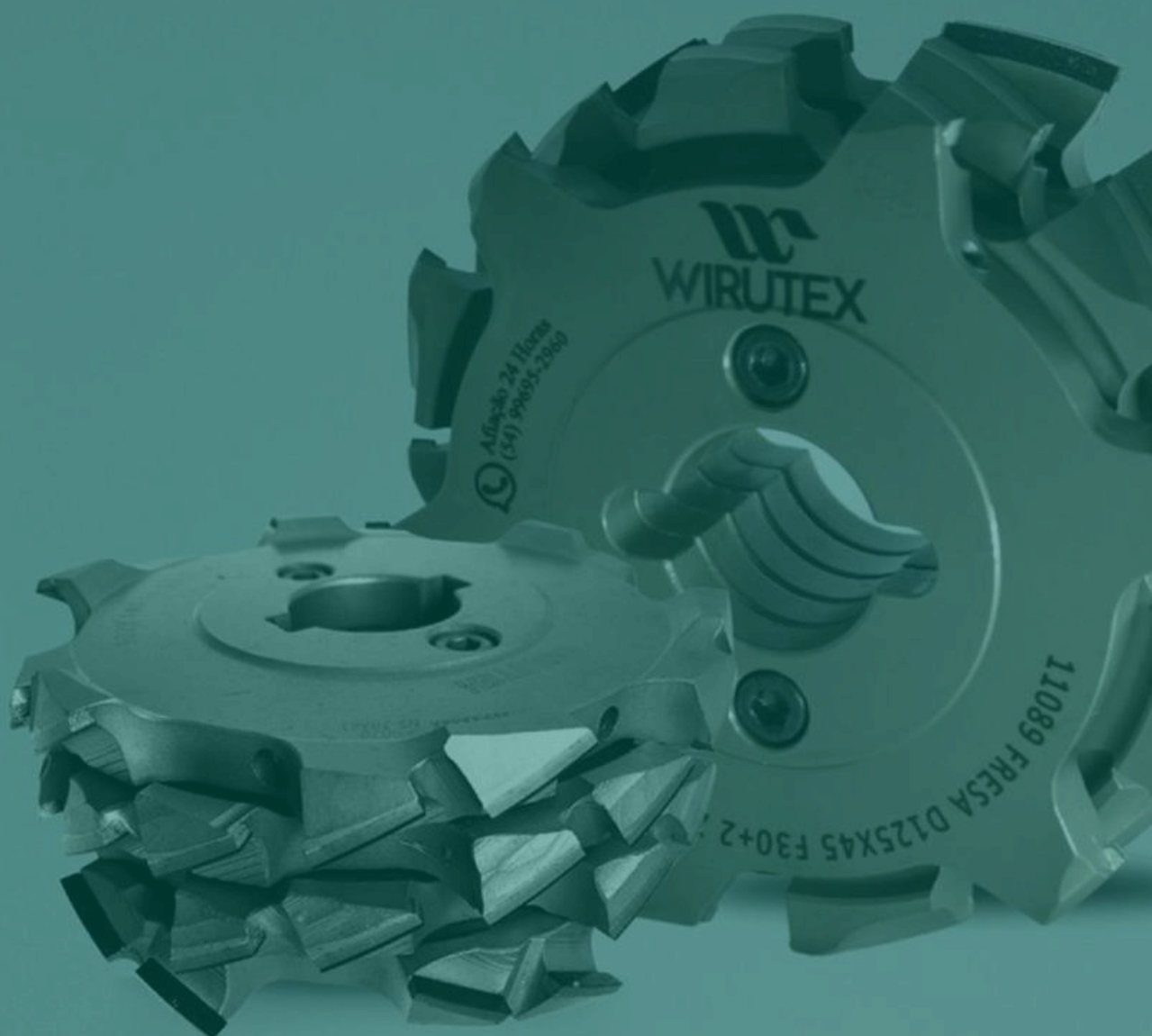

PANEL SAWS

Maximum performance and durability in panel cutting

One of the most traditional machines in furniture manufacturing plants and essential for streamlining production. By using Wirutex's diamond saws and scoring blades, you can fully exploit your machine's production capacity, with tool durability, improved logistics, and cost savings.



ATTACK CIRCULAR SAWS

WITH PCD TEETH FOR PANEL SAWS

Wirutex Attack Circular Saws, with PCD Diamond teeth, are high-performance tools for cutting panels in general, including raw and coated MDF, in conjunction with the Wirutex scorer. Consult our technical team for more information and available special projects.

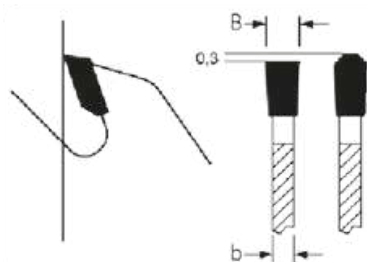

Code	D Tool diameter (mm)	Cutting thickness	Z Number of teeth	F Hole (mm)
6568	250	3,2	60	50
1903	250	4,2	60	55
9295	290	3,2	60	55
10160	290	4,2	60	55
5160	300	4,4	60	50
12521	300	4,4	64	60
3104	350	4,4	72	50
13264	350	4,4	72	55
6540	390	4,8	60	60
10408	400	4,4	72	50
13645	430	4,4	72	65
12050	430	4,8	65	54
4779	430	4,8	72	70
7840	460	5,0	60	60
14962	470	4,4	72	75
4686	470	4,8	72	70
1643	480	4,8	72	75
12740	510	4,8	60	80
10438	510	4,8	72	80
10716	570	5,0	72	75
5456	570	5,6	60	60
13213	570	5,8	60	70

ATTACK SCORING BLADES

WITH PCD TEETH FOR PANEL SAWS

Wirutex Attack Scoring Blades, with PCD Diamond teeth, assist the Wirutex Attack Saws for a more precise cut, providing greater durability and efficiency in your process. Consult our technical team for more information and available special projects.

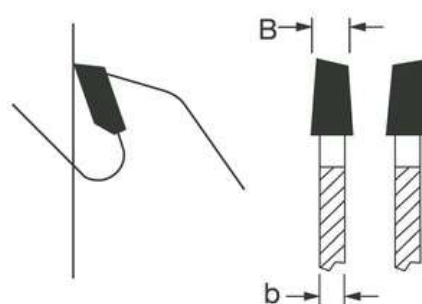

Code	D Tool diameter (mm)	Cutting thickness (mm)	Z Number of teeth	F Hole (mm)
3960	115	4,2 - 5,2	24	45
2031	150	4,4 - 5,4	24	45
5870	180	4,4 - 5,4	30	50
5189	180	5,0 - 6,0	30	45
2328	200	4,4 - 5,4	30	65
1005	200	4,8 - 5,8	30	65
3415	200	4,8 - 5,8	36	65
2608	200	5,6 - 6,6	30	45
13214	200	5,8 - 6,8	36	65

CNC MACHINING CENTER

High performance, with precision and finishing

The most versatile machine for the furniture and wood industry becomes complete with the numerous operational possibilities offered by cutters and accessories made by Wirutex Brazil. In addition to solutions tailored to each customer's needs, Wirutex also offers greater durability, better finishing, higher feed speeds, and more operational efficiency (profitability).



WIRUTEX
BRAZIL

CUTTERS FOR GROOVED PANELS

Wirutex presents its cutter for grooved panels, the ultimate solution for producing grooves in raw or coated MDF, primarily used as tracks for product support in commercial environments. It helps with edge breaking and provides an excellent final finish due to its extremely delicate machining. Consult our technical team for more information.

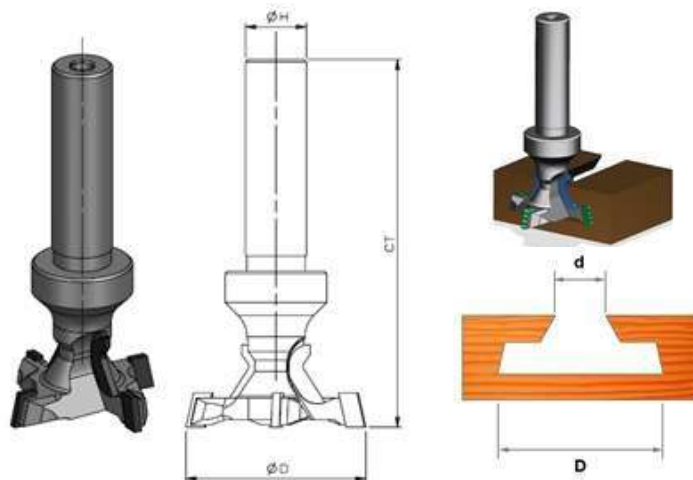

Code right rotation	D Cutting diameter (mm)	H Shank diameter (mm / in)	B Cutting height (mm)	CT Total length (mm)	Z Number of teeth
7023 US	10,6/35	12,7 / 1/2"	13	73	4+2
11105 US	10,6/35	15,88 / 5/8"	13,5	73	4+2
13418 US	13,2/35	12,7 / 1/2"	12,5	73	4+2
10081 US	10,6/35	19,05 / 3/4"	13	73	4+2

CUTTERS FOR MAKING CABINET DOORS

One of the most well-known details in woodworking, adding beauty, prominence, and value to furniture pieces and doors. With diamond cutters developed with high technology and special designs by Wirutex, you achieve high-level results, cutting precision, and finishing. Consult our technical team for more information and available special projects.



CÓD: 8507
CANTOS: 8508 e 7053



CÓD: 8509
CANTOS: 8508 e 7081



CÓD: 8900
CANTOS: 7927

Code right rotation	D Cutting diameter (mm)	H Shank diameter (mm / in)	Z Number of teeth
8507 US	35	15,88 / 5/8"	2
8508 US	12	12,7 / 1/2"	2
7053 US	16	12,7 / 1/2"	1
8509 US	30	15,88 / 5/8"	2
7081 US	6	6,35 / 1/4"	1
8900 US	48	19,05 / 3/4"	2
7927 US	25	19,05 / 3/4"	2

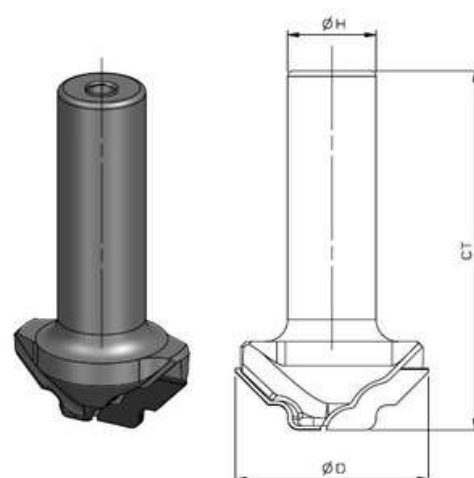

CUTTERS FOR RECESSED HANDLES

Recessed handles have become a major trend in the furniture sector worldwide. Wirutex's diamond cutters are suitable to various types of profiles and materials, such as MDF and solid wood, with perfect finishes. Consult our technical team for more information and details on available special projects.

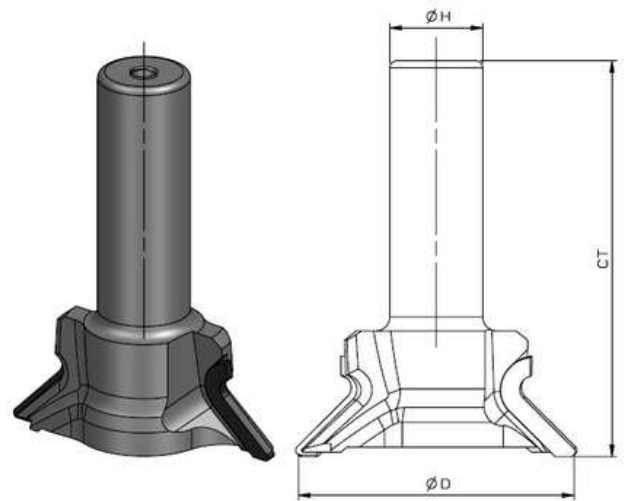

Code	D Cutting diameter (mm)	H Shank diameter (mm / in)	Z Number of teeth
6360 US	60	19,05 / 3/4"	2
6583 US	39	19,05 / 3/4"	2
7332 US	48	19,05 / 3/4"	2
7474 US	45	19,05 / 3/4"	3
9098 US	40	19,05 / 3/4"	3
14155 US	42	15,88 / 5/8"	2

CUTTERS FOR 45° CUTTING

For machining at a 45° angle, both in profiles and grooves, Wirutex diamond tools offer excellent performance, durability, and finish. These tools can be used on Machining Centers (CNC) with vacuum pods and CNC Nesting, in Z2 and Z3 options, and are suitable for materials such as MDF, MDP, and solid wood. Please consult our technical team for more information and available special projects.

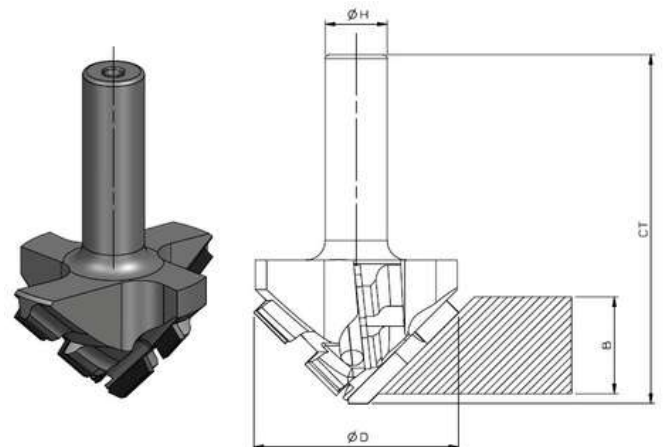

Code	D Cutting diameter (mm)	H Shank diameter (mm / in)	B Cutting height (mm)	CT Total length (mm)	Z Number of teeth
10113 US	50	19,05 / 3/4"	18	80	3
6551 US	66	19,05 / 3/4"	25	90	3
6617 US	82	19,05 / 3/4"	35	100	3

TOP GROOVES CUTTERS 30°

Wirutex closely follows market trends. Today, it is common to machine details such as grooves and recesses, which become more delicate in materials like MDF panels and solid wood. Designed internally by Wirutex engineering to perform finishing on recesses, meeting the needs of contemporary designs with excellent finishing. Consult our technical team for more information and special projects available.

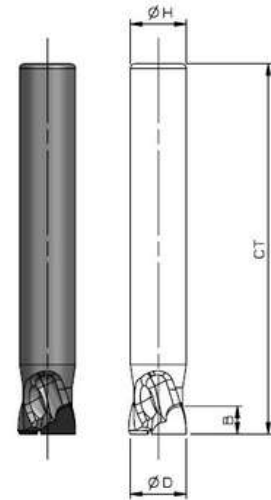

Code	D Cutting diameter (mm / in)	H Shank diameter (mm / in)	B Cutting height (mm / in)	CT Total length (mm / in)	Z Number of teeth
10398 US	9,5 / 3/8"	9,5 / 3/8"	6,35 / 1/4"	63,6 / 2 1/2"	2
8599 US	12,7 / 1/2"	12,7 / 1/2"	6,35 / 1/4"	79,4 / 3 1/8"	2
8745 US	15,9 / 5/8"	12,7 / 1/2"	6,35 / 1/4"	79,4 / 3 1/8"	2

PCD CUTTERS WITH SOLID CARBIDE OR HEAVY METAL BODY

Mainly used for making grooves or recesses, and in some cases, for cutting. Wirutex develops cutters with bodies made of Solid Carbide and also Heavy Metal (Densimet®), to enable machining with smaller diameters, such as grooves for bottoms fitting, while maintaining the quality of the finish. Consult our technical team for more information and special projects available.

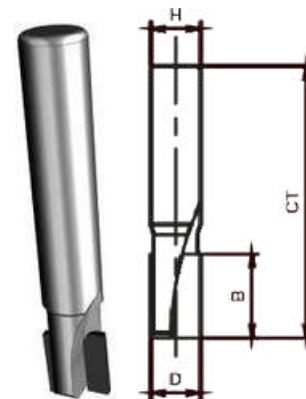

Code	D Cutting diameter (mm / in)	H Shank diameter (mm / in)	B Cutting height (mm / in)	CT Total length (mm / in)	Z Number of teeth
7082 US	6,35 / 1/4"	12,7 / 1/2"	6,35 / 1/4"	55,56 / 2 3/16"	1
7084 US	7,14 / 9/32"	9,53 / 3/8"	7,94 / 5/16"	65,09 / 2 9/16"	2
7087 US	7,94 / 5/16"	12,7 / 1/2"	7,94 / 5/16"	55,56 / 2 3/16"	2
7094 US	9,53 / 3/8"	22,23 / 7/8"	9,53 / 3/8"	65,09 / 2 9/16"	2
17897 US	6,35 / 1/4"	12,7 / 1/2"	12,7 / 1/2"	60,33 / 2 3/8"	2
17898 US	7,14 / 9/32"	12,7 / 1/2"	12,7 / 1/2"	60,33 / 2 3/8"	2
17899 US	7,94 / 5/16"	12,7 / 1/2"	12,7 / 1/2"	60,33 / 2 3/8"	2
17900 US	9,53 / 3/8"	22,23 / 7/8"	12,7 / 1/2"	60,33 / 2 3/8"	2

ECO Z1 CUTTER

Milling cutter recommended for lower cutting volumes that do not require high feed rates. An excellent solution for achieving a relatively high cutting height in smaller diameters and suitable for operations where the milling cutter enters the panel solely along the "z" axis, such as in machining centers that do not have ramp or helical entry options. Please consult our technical team for more information and available special projects.

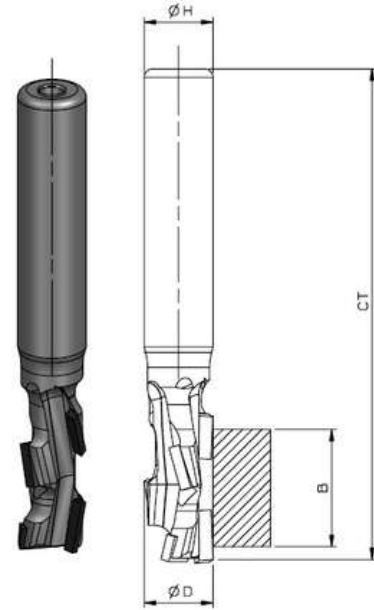

Code	D Cutting diameter (mm / in)	H Shank diameter (mm / in)	B Cutting height (mm / in)	CT Total length (mm)	Z Number of teeth
6108 US	12,7 / 1/2"	12,7 / 1/2"	19,05 / 3/4"	85	1
6110 US	12,7 / 1/2"	12,7 / 1/2"	25,4 / 1"	90	1
6112 US	12,7 / 1/2"	12,7 / 1/2"	30,16 / 1 3/16"	95	1
6118 US	15,9 / 5/8"	15,9 / 5/8"	30,16 / 1 3/16"	95	1
6140 US	19,05 / 3/4"	19,05 / 3/4"	44,45 / 1 3/4"	110	1

W-TECH Z2 CUTTER

The W-Tech Z2 line from Wirutex features a geometry designed to provide an excellent finish, even on panels with critical coatings, such as High Gloss. Please consult our technical team for more information and available special projects.

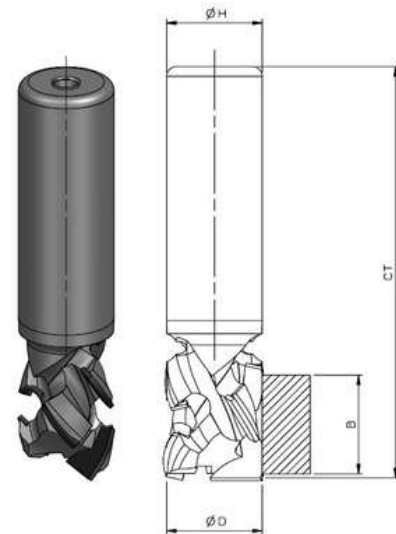

Code	D Cutting diameter (mm / in)	H Shank diameter (mm / in)	B Cutting height (mm / in)	CT Total length (mm)	Z Number of teeth
17441 US	15,9 / 5/8"	15,9 / 5/8"	38,1 / 1 1/2"	100	2
15111 US	19,05 / 3/4"	19,05 / 3/4"	38,1 / 1 1/2"	100	2
12499 US	25.4 / 1"	19,05 / 3/4"	38,1 / 1 1/2"	105	2

ONE PASS CUTTER

Developed internally by Wirutex Engineering, this is a revolutionary project for cutting solid wood on Machining Centers. The application of PDC Diamond technology to the innovative milling cutter design elevates this line to a level far superior to other tools available on the market in Carbide. It offers unparalleled durability and finish, making it excellent for contouring and cutting tasks. Please consult our technical team for more information and available special projects.

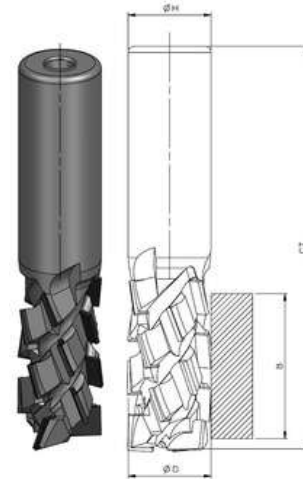

Code	D Cutting diameter (mm / in)	H Shank diameter (mm / in)	B Cutting height (mm / in)	CT Total length (mm)	Z Number of teeth
11795 US	19,05 / 3/4"	19,05 / 3/4"	19,05 / 3/4"	75	3
11748 US	19,05 / 3/4"	19,05 / 3/4"	25,4 / 1"	80	3
11794 US	19,05 / 3/4"	19,05 / 3/4"	30,16 / 1 ³ / ₁₆ "	90	3
11676 US	19,05 / 3/4"	19,05 / 3/4"	34,93 / 1 ³ / ₈ "	95	3
11793 US	25,4 / 1"	25,4 / 1"	19,05 / 3/4"	80	3
11792 US	25,4 / 1"	25,4 / 1"	25,4 / 1"	90	3
11605 US	25,4 / 1"	25,4 / 1"	30,16 / 1 ³ / ₁₆ "	95	3
11780 US	25,4 / 1"	25,4 / 1"	34,93 / 1 ³ / ₈ "	95	3

ONE PASS Z3 MILLING CUTTER FOR CONTOURS

With the same design as the One Pass Milling Cutter, this tool is specifically for contours, such as table legs, chairs, and other applications. Wirutex presents a robust milling cutter that allows for machining at even greater heights, with higher speed and increased durability. Its finish quality, whether on MDF, solid wood, or particleboard, surpasses other carbide milling cutters available on the market, even reducing the need for sanding. Please consult our technical team for more information and available special projects.

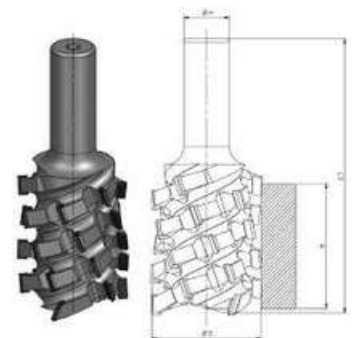

Code	D Cutting diameter (mm / in)	H Shank diameter (mm / in)	B Cutting height (mm / in)	CT Total length (mm)	Z Number of teeth
12211 US	47,6 / 1 ⁷ / ₈ "	19,05 / 3/4"	19,05 / 3/4"	95	3
12096 US	47,6 / 1 ⁷ / ₈ "	19,05 / 3/4"	34,93 / 1 ³ / ₈ "	120	3
11867 US	47,6 / 1 ⁷ / ₈ "	19,05 / 3/4"	41,28 / 1 ⁵ / ₈ "	115	3
11893 US	47,6 / 1 ⁷ / ₈ "	19,05 / 3/4"	50,8 / 2"	115	3
11656 US	47,6 / 1 ⁷ / ₈ "	19,05 / 3/4"	55,56 / 2 ³ / ₁₆ "	120	3
11566 US	47,6 / 1 ⁷ / ₈ "	19,05 / 3/4"	60,33 / 2 ³ / ₈ "	125	3
11789 US	47,6 / 1 ⁷ / ₈ "	19,05 / 3/4"	79,38 / 3 ¹ / ₈ "	145	3

MASTER SPEED Z5 LINE

Developed specifically for cutting MDF and MDP on Machining Centers with vacuum pods, it offers superior performance at high speeds. This milling cutter is ideal for those seeking productivity gains without sacrificing finish quality, even in large-scale production. Please consult our technical team for more information and available special projects.

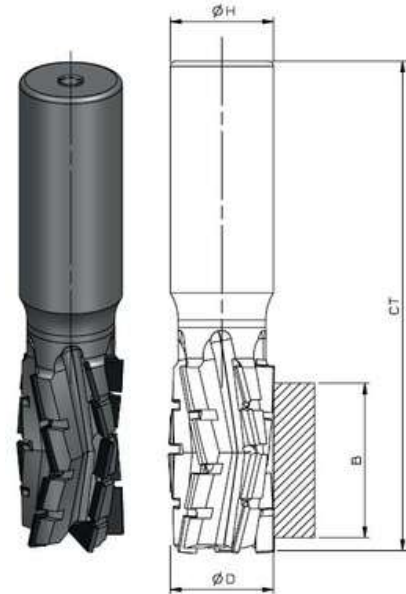

Code	D Cutting diameter (mm / in)	H Shank diameter (mm / in)	B Cutting height (mm / in)	CT Total length	Z Number of teeth
11470	20	20	18	80	5
12142	20	20	25	90	5
9670	20	20	30	95	5
11438	25	25	40	100	5
10584	25	25	50	110	5

GROOVING SAW

A versatile tool that can be used in Machining Centers, Edge Banders, Drilling Centers, and Routers. It is the fastest and most durable way to create grooves in the bottom of furniture pieces compared to straight-cut milling cutters that perform the same process. Contact our technical team for more information and available custom projects.

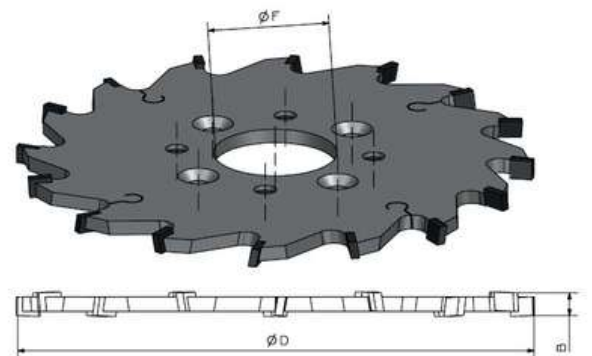

Code	D Cutting diameter (mm)	F Central bore diameter (mm)	B Groove cutting thickness (mm)	Z Number of teeth
3289	100	30	4,0	12
3225	120	20+3	4,0	12
4847	125	30	4,0	12
17620	120	20+3	7,0	24
17621	125	20+3	7,0	24

FOLDING CUTTER

We present the Folding Cutter for bending MDF and MDP. Developed and manufactured by Wirutex Brazil, it is one of the most innovative and in-demand tool in recent times. It can be used in CNC Routers, Machining Centers with Pads, and CNC Nesting. It is recommended to use appropriate materials (unlaminated MDF or MDP) with more flexible edges. Contact our technical team for more information.

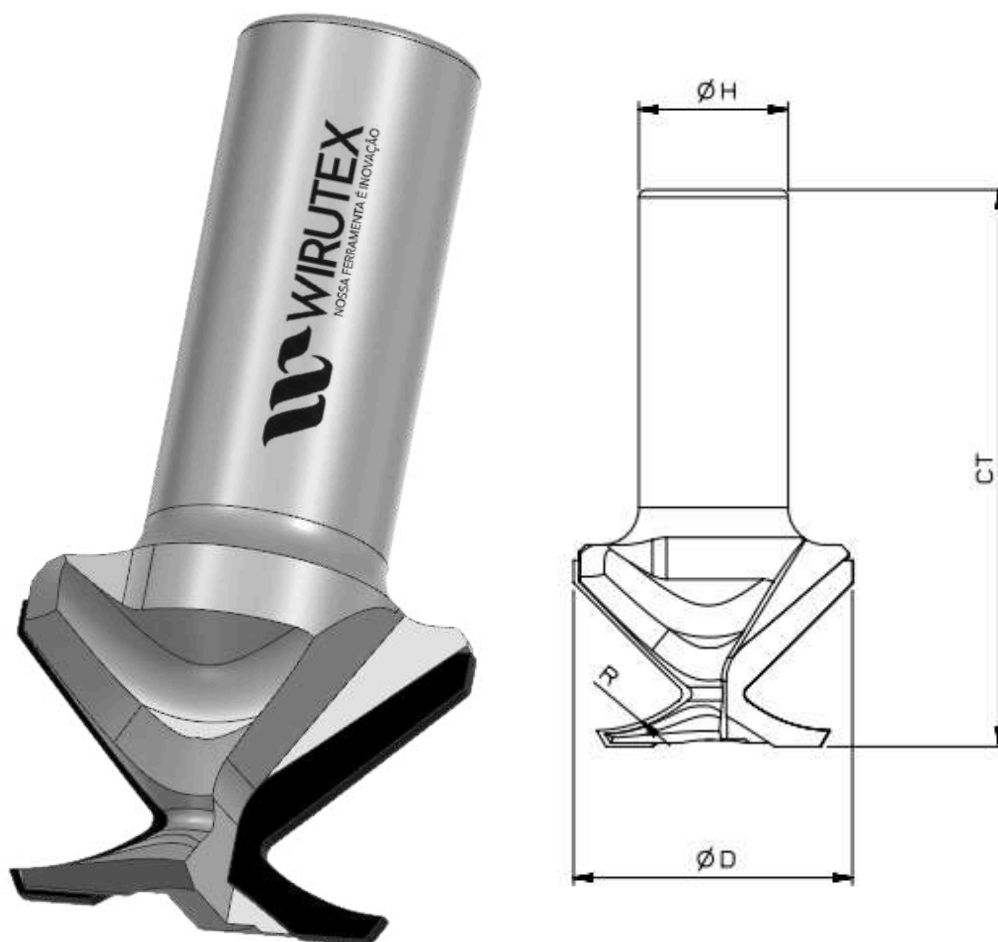

Code	D Cutting diameter (mm / in)	H Shank diameter (mm / in)	B Cutting thickness (mm)	R Tool radius (mm / in)	CT Total length (mm)	Z Number of teeth
18015	50,2	19,05 3/4"	25,40 1"	30	76,2 3"	2
18016	37,2	19,05 3/4"	19,05 3/4"	18	76,2 3"	2
18455	50,2	15,88 5/8"	25,40 1"	30	76,2 3"	2
19021	37,2	15,88 5/8"	19,05 3/4"	18	76,2 3"	2

CONVENTIONAL NESTING Z3 MILLING CUTTER

This tool offers a combination of performance and cost-effectiveness. It provides an excellent finish for machining raw materials such as MDP and MDF (with or without coating). Please consult our technical team for more information and available special projects.

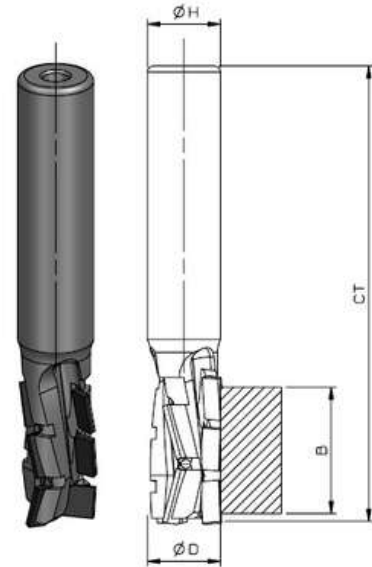

Code	D Cutting diameter (mm / in)	H Shank diameter (mm / in)	B Cutting height (mm / in)	CT Total length (mm)	Z Number of teeth
5708 US	12,7 / 1/2"	12,7 / 1/2"	19,05 / 3/4"	75	3
5695 US	12,7 / 1,2"	12,7 / 1/2"	25,4 / 1"	80	3
5712 US	14,3 / 9/16"	15,88 / 5/8"	25,4 / 1"	80	3
5780 US	14,4 / 9/16"	15,88 / 5/8"	31,75 / 1 1/4"	85	3

MASTER Z2 NESTING MILLING CUTTER

The Wirutex Master Z2 Nesting Milling Cutter combines performance with versatility. It is ideal for companies with a wide range of products that require efficiency and durability in their tools. It can be perfectly applied to machining materials such as MDF, MDP, and laminates, whether on robust Nesting CNCs or on routers and lower-power CNCs. Please consult our technical team for more information and available special projects.

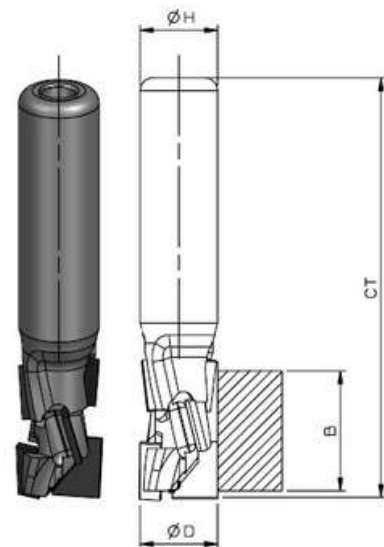

Code	D Cutting diameter (mm / in)	H Shank diameter (mm / in)	B Cutting height (mm / in)	CT Total length (mm)	Z Number of teeth
12517 US	9,53 / 3/8"	12,7 / 1/2"	19,05 / 3/4"	65	2
12507 US	12,7 / 1/2"	12,7 / 1/2"	19,05 / 3/4"	65	2
12508 US	12,7 / 1/2"	12,7 / 1/2"	25,4 / 1"	70	2
12515 US	14,3 / 9/16"	15,88 / 5/8"	31,75 / 1 1/4"	75	2

MASTER Z3 NESTING MILLING CUTTER

If you're looking for performance on a Nesting CNC, this is the right tool. By combining durability, precision, and technology with its innovative geometry, it allows for high speeds while maintaining an impeccable finish. Please consult our technical team for more information and available special projects.

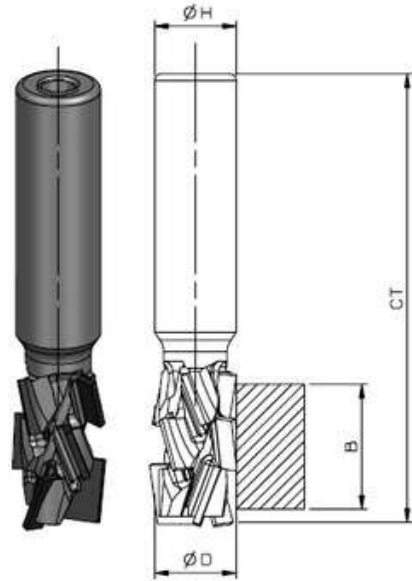

Code	D Cutting diameter (mm / in)	H Shank diameter (mm / in)	B Cutting height (mm / in)	CT Total length (mm)	Z Number of teeth
12240 US	12,7 / 1/2"	12,7 / 1/2"	19,05 / 3/4"	65	3
12202 US	12,7 / 1/2"	12,7 / 1/2"	25,4 / 1"	70	3
12271 US	14,3 / 9/16	15,88 / 5/8"	25,4 / 1"	75	3
12229 US	14,3 / 9/16	15,88 / 5/8"	33,34 / 1 5/16"	75	3

CHRONOS Z4 NESTING MILLING CUTTER

The ultimate milling cutter for Nesting CNCs, developed and manufactured pioneering by Wirutex Brazil, with a patent pending. It uniquely combines speed and quality in cutting, bringing greater efficiency and productivity to the industry. It can also be used in the Z5 configuration and in conjunction with the Thermal Cone Kit and Turbine. Please consult our technical team for more information and available special projects.

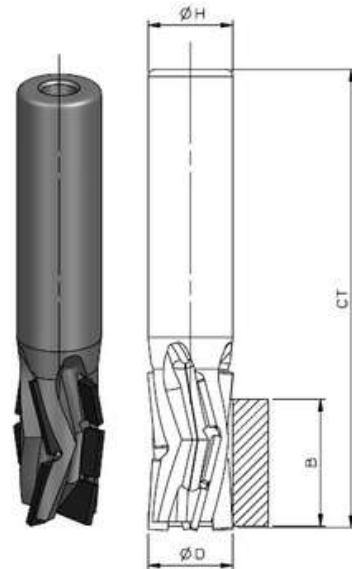

Code	D Cutting diameter (mm / in)	H Shank diameter (mm / in)	B Cutting height (mm / in)	CT Total length (mm)	Z Number of teeth
14220 US	12,7 / 1/2"	12,7 / 1/2"	19,05 / 3/4"	65	4
14221 US	12,7 / 1/2"	12,7 / 1/2"	25,4 / 1"	70	4
14645 US	14,3 / 9/16"	15,88 / 5/8"	25,4 / 1"	70	4
14960 US	14,3 / 9/16"	15,88 / 5/8"	31,75 / 1 1/4"	80	4

ACM CUTTING MILLING CUTTER

Designed and manufactured by Wirutex Brazil, the ACM Cutting Milling Cutter is one of the major innovations for the visual communication industry. The application of PDC Diamond technology brings a new level of finish and precise cutting, reflecting in the quality of the final product. Please consult our technical team for more information and available special projects.

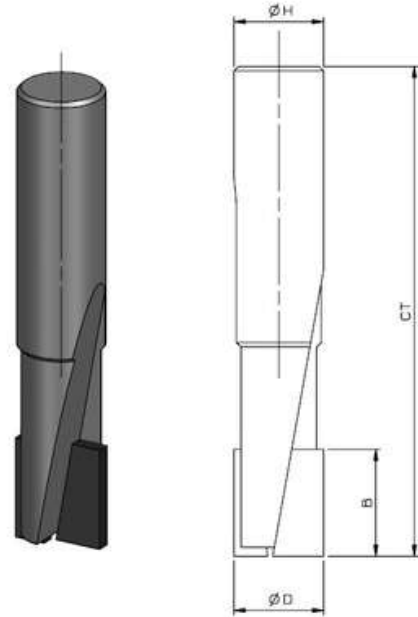

Code	D Cutting diameter (mm / in)	H Shank diameter (mm / in)	B cutting height (mm / in)	CT Total length (mm / in)	Z Number of teeth
7084 US	6,35 / 1/4"	7,94 / 5/16"	11,11 / 7/16"	55	2
8565 US	7,94 / 5/16"	7,94 / 5/16"	7,94 / 5/16"	55	1

ACM BENDING MILLING CUTTER

Alongside the ACM Cutting Milling Cutter, the ACM Bending Milling Cutter is another major innovation introduced by Wirutex Brazil. The application of PDC Diamond technology delivers an excellent finish, reducing the need for sanding and deburring in the ACM bending process. Please consult our technical team for more information and available special projects.

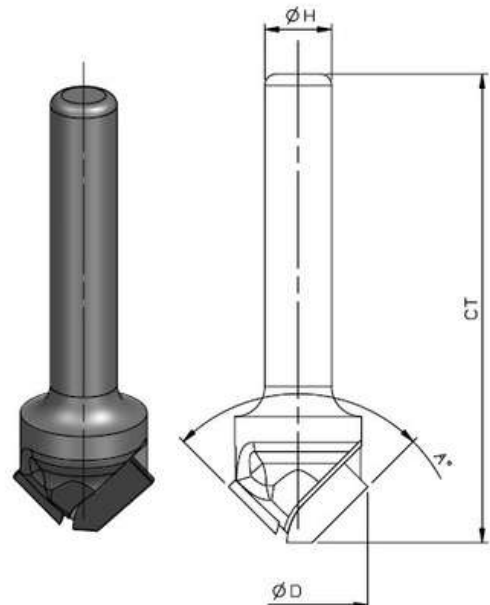

Code	D Cutting diameter (mm / in)	H Shank diameter (mm / in)	B Cutting height (mm / in)	CT Total length (mm)	Z Number of teeth
12622 US	12,7 / 1/2"	6,35 / 1/4"	6,35 / 1/4"	42	2

BALL NOSE MILLING CUTTERS

These are rounded end milling tools with a spherical cutting area. They are ideal for roughing and creating channels that require a smooth finish and surface. Please consult our technical team for more information and available special projects.

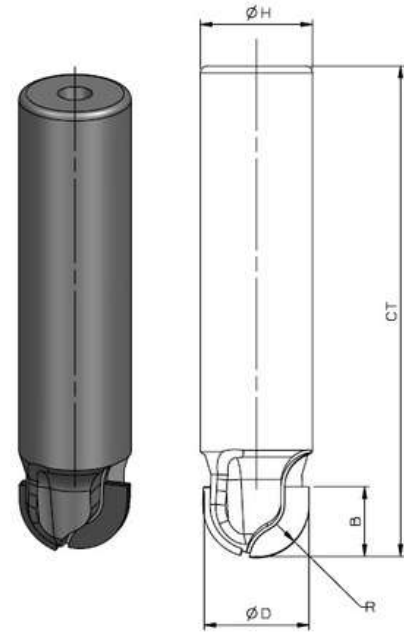

Code	D Cutting diameter (mm / in)	H Shank diameter (mm / in)	B Cutting height (mm / in)	R Tool radius (mm / in)	CT Total length (mm)	Z Number of teeth
15705 US	6,35 / 1/4"	6,35 / 1/4"	9,53 / 3/8"	3,18 / 1/8"	55	1
15706 US	9,53 / 3/8"	12,7 / 1/2"	9,53 / 3/8"	4,76 / 3/16"	60	2
17676 US	15,88 / 5/8"	15,88 / 5/8"	15,88 / 5/8"	7,94 / 5/16"	70	2

FACE MILL

This tool, designed by Wirutex, performs the facing of CNC Nesting and Router Sacrificial Plates with perfection. It eliminates grooves and small channels that can cause poor clamping of the workpieces, thus preventing vibrations and movement of the plate. It comes in various diameters and has a long service life. Please consult our technical team for more information and available special projects.

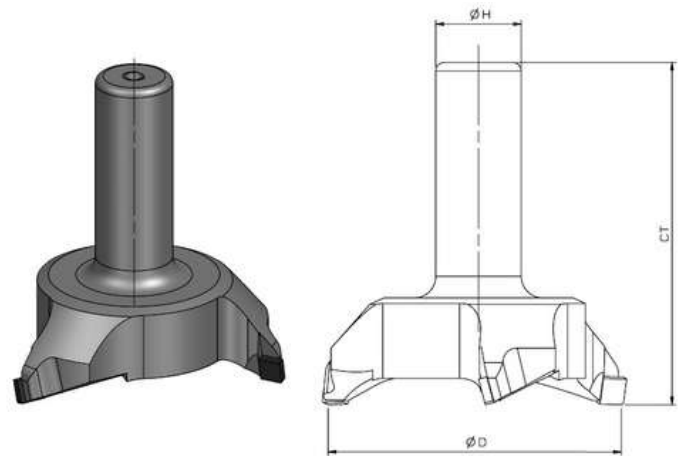

Code	D Cutting diameter (mm / in)	B Cutting height (mm / in)	H Shank diameter (mm / in)	CT Total length (mm)	Z Number of teeth
6299 US	50,8 / 2"	6,35 / 1/4"	15,88 / 5/8"	70	3
12335 US	76,2 / 3"	6,35 / 1/4"	19,05 / 3/4"	65	3
12332 US	101,6 / 4"	6,35 / 1/4"	19,05 / 3/4"	80	3
4247 US	152,4 / 6"	6,35 / 1/4"	25,4 / 2"	85	5

INTERCHANGEABLE INSERTS

Code	Cutting L	length dimensions (mm)		Z (mm)
		W	T	
12004RV	20	12	1,5	2
12005RV	30	12	1,5	2
12014RV	40	12	1,5	2
12006RV	50	12	1,5	2

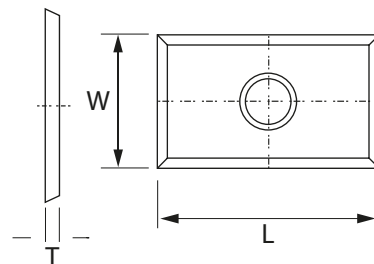

Code	Cutting L	length dimensions (mm)		Z (mm)
		W	T	
12002RV	12	12	1,5	4
13273RV	14	14	2	4
13329RV	14,3	14,3	2,5	4
13315RV	15	15	2,5	4
15949RV	15	15	2,5	4

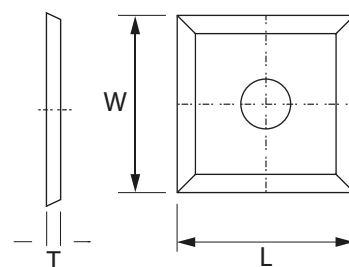

Code	Cutting L	length dimensions (mm)		R (mm)
		W	T	
16510RV	16	17,5	2	2
16511RV	16	17,5	2	3

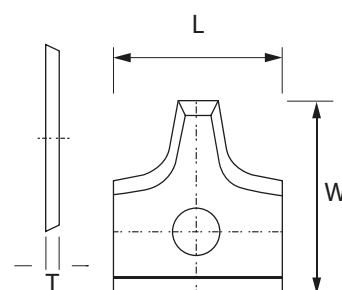

Code	Cutting L	length dimensions (mm)		R (mm)
		W	T	
18412R15RV	18,4	12	2	1,5

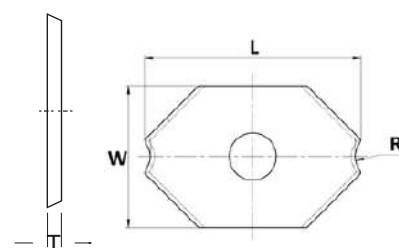

CLAMPING SYSTEM

Just as important as having the right tool for your process, the clamping of the tool directly impacts the quality of machining and the tool's lifespan. With this in mind, Wirutex Brazil develops and manufactures high-performance clamping components that ensure maximum precision in operation and operational efficiency

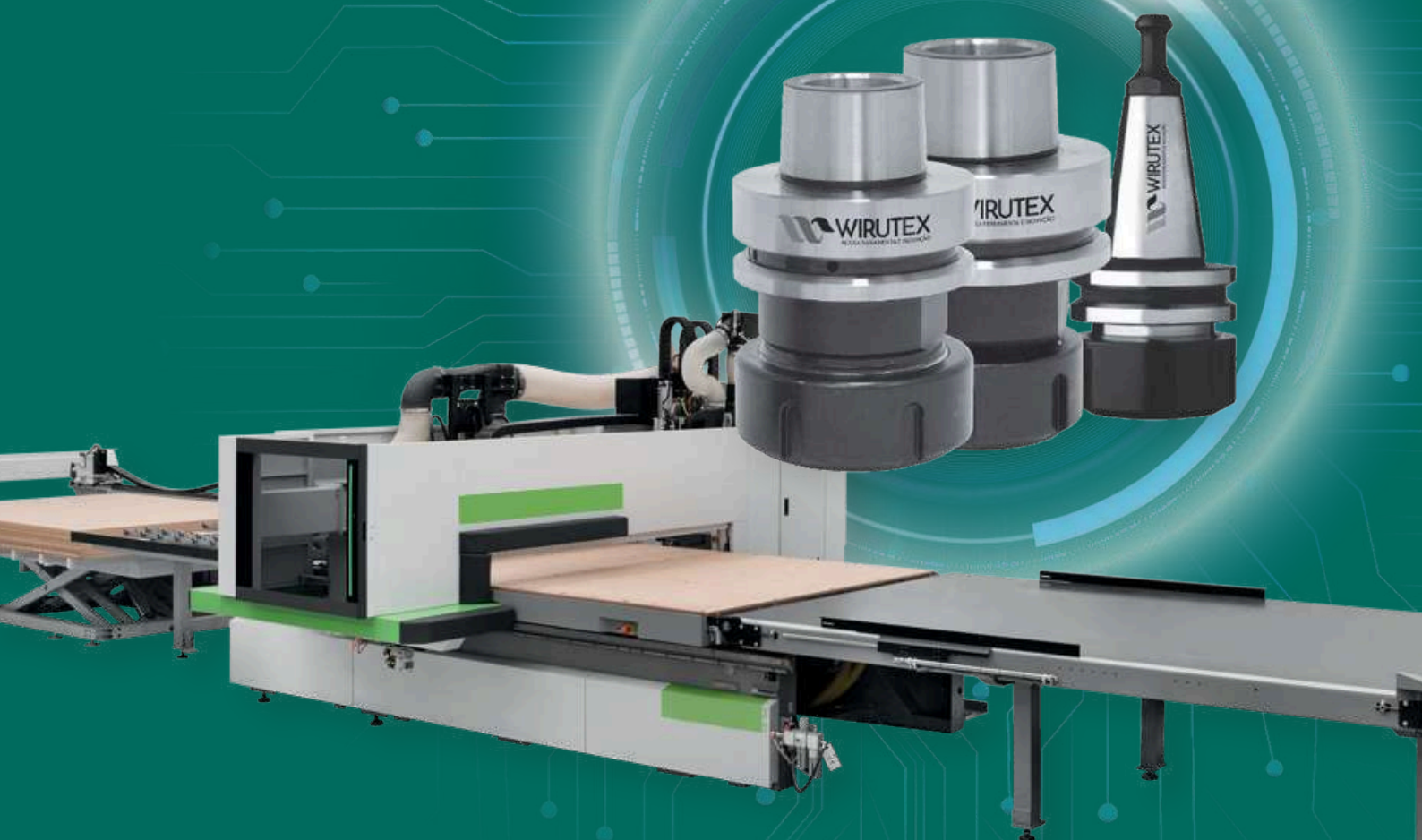

TURBINES

WITHOUT GRILLE

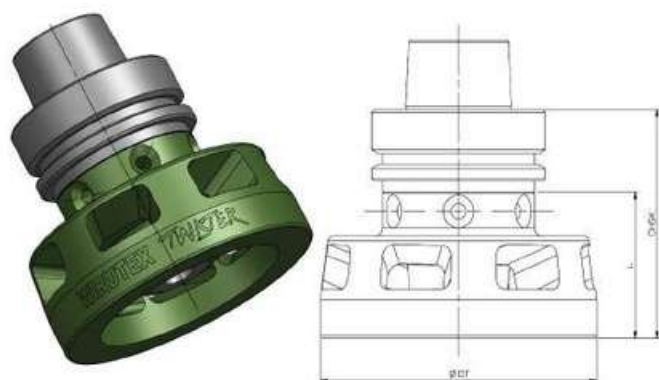

WITH GRILLE

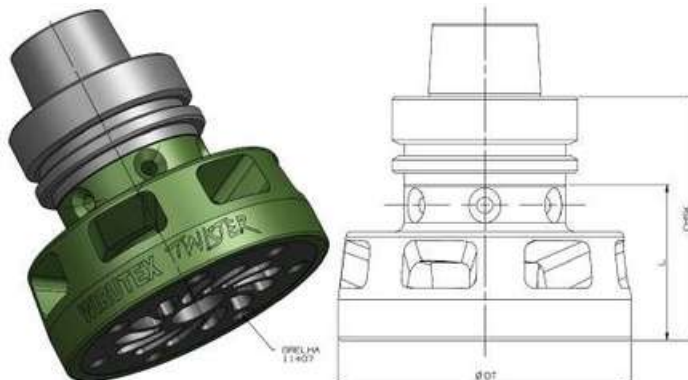

Code Right Rotation	DT turbine diameter (mm)	L turbine width (mm)	CHSK Turbine length with HSK cone (mm)	CISO Turbine length with ISO cone (mm)	NH number of blades
11405 - Without Grille	100	53	83	74	7
12963 - With Grille	100	53	83	74	7

WITHOUT GRILLE

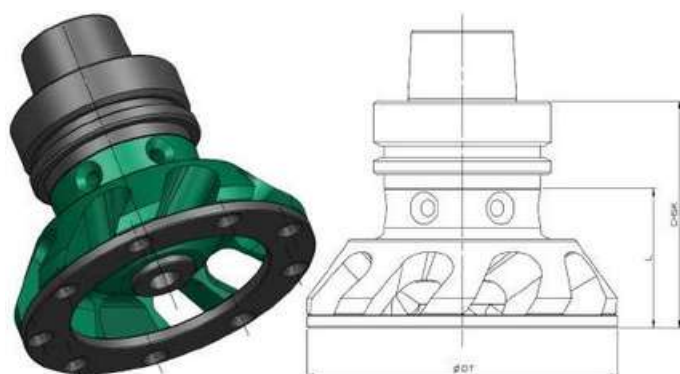

WITH GRILLE

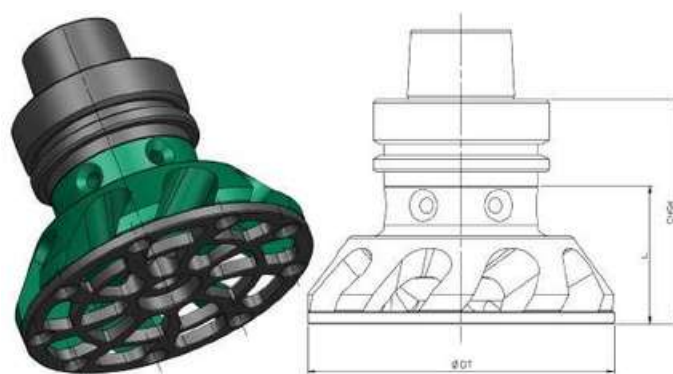

Code Right Rotation	DT Turbine diameter(mm)	L Turbine width (mm)	CHSK Turbine length with HSK cone (mm)	CISO Turbine length with ISO cone (mm)	NH Number of blades
17299 - Without Grille	110	49,5	80,5	71,5	9
17300 - With Grille	110	49,5	80,5	71,5	9

TURBINE FOR ER COLLETS

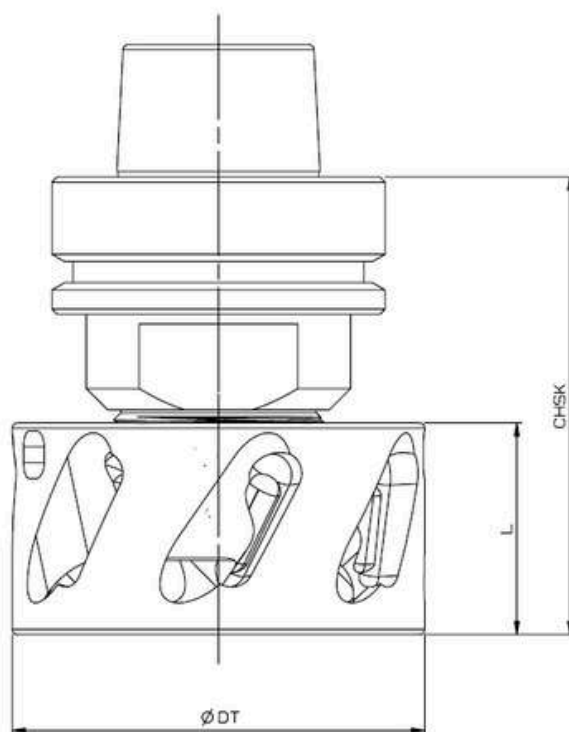

Code Right Rotation	DT Turbine diameter (mm)	L Turbine width (mm)	CHSK Turbine length with HSK cone (mm)	CISO Turbine length with ISO cone (mm)	NH Number of blades
TWER25	78	40	83	63	7
TWER32	78	40	83	63	7
TWER40	83	40	83	63	7

ISO 30 COLLET HOLDER

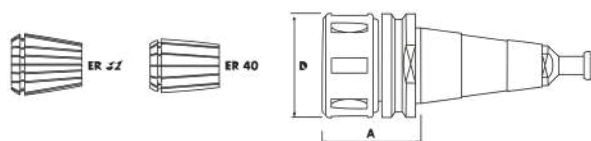

Code Right Rotation	D	A	Collet	NORMA
18320001	50	50	ER 32	ISO 30
18320101	63	60	ER 40	ISO 30

HSK 63F COLLET HOLDER

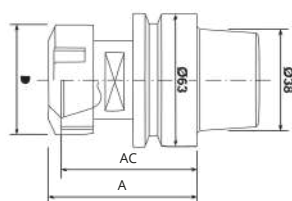

Code Right Rotation	D	A	Collet	NORMA
18330001	50	70	ER 32	HSK - 63F
18331001	63	80	ER 40	HSK - 63F

BHX HOLDER

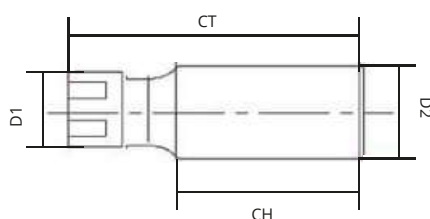

Code Right Rotation	CT Total length(mm)	D1 Collet standard	D2xCH Diameter of the shank X length (mm)
8806WR	110	ER 16	H20X65
8164WR	90	ER 16	H25X45

ISO 30 THERMO HOLDER FOR TURBINE

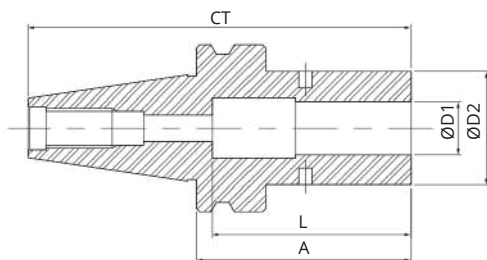

Code Right Rotation	D1 Shank diameter (mm)	D2 Smaller external diameter (mm)	L Fitting length (mm)	A Distance between flanges (mm)	CT Total length
5794WR	12	24	55	65	116
5795WR	16	27	55	65	116

HSK 63F THERMO HOLDER FOR TURBINE

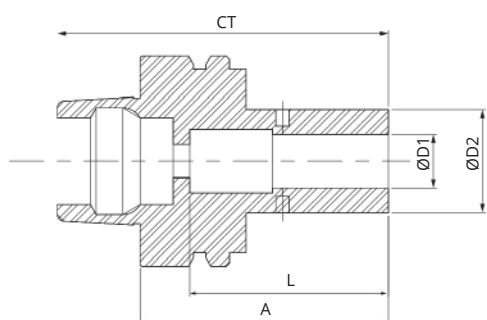

Code Right Rotation	D1 Shank diameter (mm)	D2 Smaller external diameter (mm)	L Fitting length (mm)	A distance between flanges (mm)	CT Total length
5644WR	12	24	55	75	100
5645WR	16	27	55	75	100

ISO 30 THERMO HOLDER

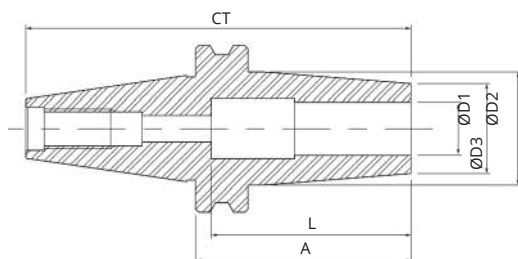

Code	D1	D2	D3	L	A	CT
Right Rotation	Shank diameter (mm)	Smaller external diameter (mm)	Larger external diameter (mm)	Fitting length (mm)	Distance between flanges (mm)	total length
5648WR	12	24	32	55	65	116
5649WR	16	27	34	55	65	116
5650WR	20	33	40	55	65	116
5651WR	25	37	42	55	65	116

HSK - 63F THERMO HOLDER

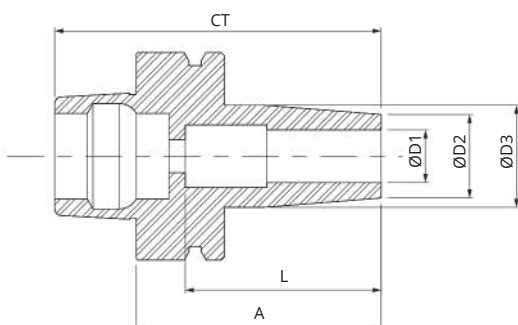

Code	D1	D2	D3	L	A	CT
Right Rotation	Shank diameter (mm)	Smaller external diameter (mm)	Larger external diameter (mm)	Fitting length (mm)	distance between flanges (mm)	Total length
8129WR	8	24	32	55	75	100
7844WR	10	24	32	55	75	100
5492WR	12	24	32	55	75	100
5493WR	16	27	34	55	75	100
5494WR	20	33	40	55	75	100
5495WR	25	37	42	55	75	100

LOCKING NUT FOR COLLET HOLDER

APPLICATION: to lock the collet

Code	D Tool Diameter (mm)	Collet
99218301	50	ER 32
99238301	63	ER 40

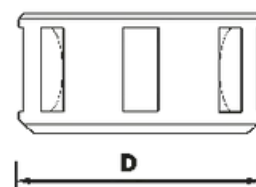

TORQUE WRENCH

APPLICATION: perfect fit, reduced risk of accidents

Code	Collet
99118300	ER 32
99128300	ER 40



EDGE BANDING MACHINE

A fundamental machine in companies that process sheet materials and similar items. It is used to finish the edges of furniture. Wirutex Brazil is one of the leading market references for edgebander tools, having pioneered the development and manufacture of the WF line. Discover the tool options that enhance your productivity, providing better finishing and greater durability.

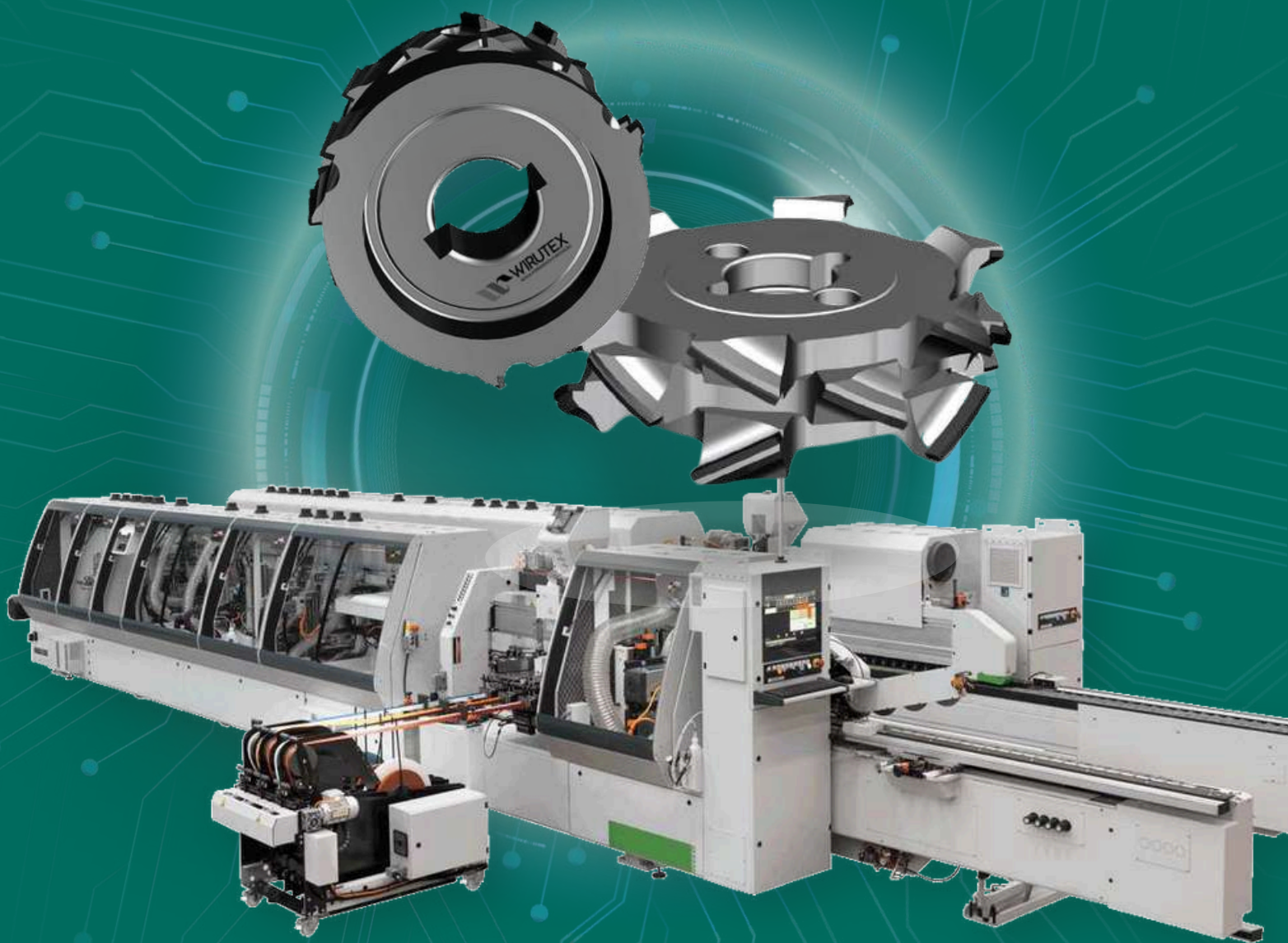

MAGNUM HOGGERS

With innovations in geometry and design, the Magnum Hogger from Wirutex, used in edge banders, provides excellent cutting performance, improving finish and increasing durability. Consult our technical team for more information and available special projects.



Code	Tool diameter	Cutting height	Z	Hole
12636-80*	250	10	36+6	80
12636-35	250	10	36+6	35
12636-40	250	10	36+6	40
12999-80*	230	10	30+6	80
12999-35	230	10	30+6	35
12999-40	230	10	30+6	40

"Without block"

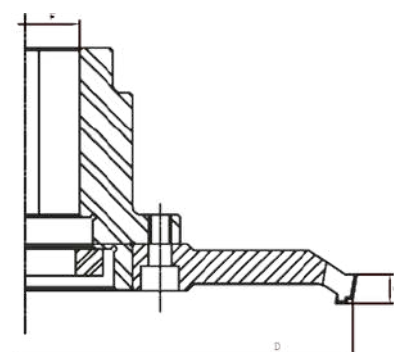

WF MODULAR SYSTEM ROUTER

Pre-milling cutter that revolutionized edge banding finishing and improved the overall process. With its greater axial angle, it provides a perfect cut, machining more smoothly without "marking" the finer edge bandings. Its durability is on average twice that of a conventional tool, enhancing the profitability of your investment. Consult our technical team for more information and available special projects.

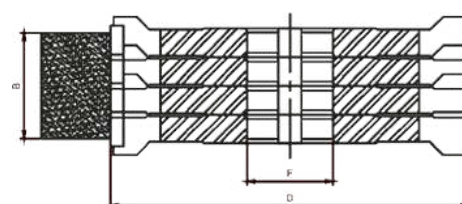

Code	Tool diameter	Panel thickness	Z	Hole	Observation
11464	120	25	6	25	-
11086	125	25	6	30	-
11089	125	40	6	30	-
12953	125	45	6	30	*BLOCK
11734	180	18	10	40	-

ALUMINUM PRE-MILLING CUTTER WITH INTERCHANGEABLE INSERTS

A cutter used in edge banding machines, providing excellent finishing and versatility due to its diamond inserts that can be replaced. Additionally, it reduces motor effort because its body is made of aluminum. Consult our technical team for more information and available special projects.

Code	Tool diameter	Panel thickness	Z	Hole
14875	80	25	3	30
17625	80	40	3	30
15088	80	40	3	20
15017	80	60	3	20
14758	100	25	3	30
15144	100	60	3	30
14806	125	25	3	30



PRE-MILLING CUTTERS FOR EDGE BANDING MACHINES

Pre-milling cutter used in the entry of edge banding machines, providing precise finishing for edge banding without marking. Wirutex's cutters will offer the productive edge your industry needs, with excellent finishing and long durability. Consult our technical team for more information and available special projects.

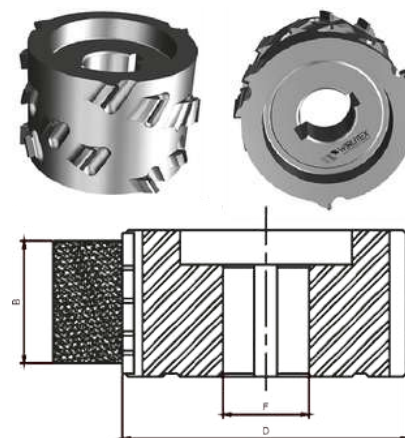
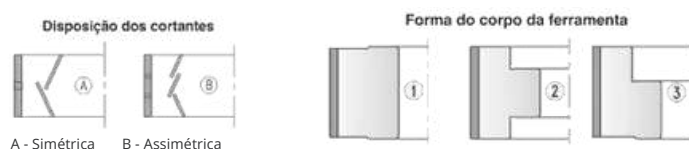

Code	Tool diameter	Panel thickness	Z	Hole	Machine
9205	80	45	3	20	INMES
5897	80	65	2	20	USIKRAFT
16035	100	65	3	30	USIKRAFT
10777	100	35	3	30	SCM
3060	100	40	3	30	SCM/HOMAG
14827	100	60	3	30	SCM
2340	100	60	3	30	IMA/HOMAG
14614	125	25	3	30	HOMAG
10807	125	50	3	30	HOMAG
6095	125	40	3	30	IMA/HOMAG
1126	125	60	3	30	BIESSE/NANXING

EDGE TRIMMER

With geometry specially developed by Wirutex's engineering team and optimized axial inclination, these trimmer are capable of machining all types of edges while consistently delivering excellent finishing with low noise. Consult our technical team for more information.

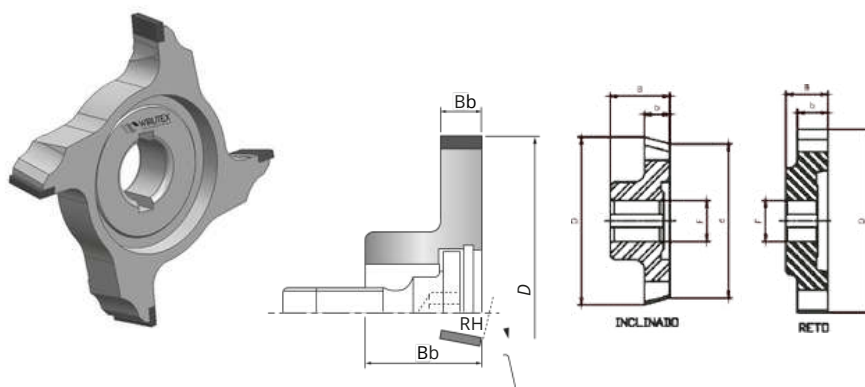

Code	D Tool diameter (mm)	d Copier diameter (mm)	B Flange height (mm)	b cutting width	F Hole (mm)	Z number of teeth	Machine
1700	75,25	68	19	10	17	6	MACLINEA
1702	70	70	17	10	17	6	MACLINEA
1595	68	61	17	12	16	6	SULAMERICANA
4968	70	70	12	12	16	6	SULAMERICANA

CUTTER FOR ROUNDING EDGES

Designed to reduce noise and improve waste flow, this cutter bit is ideal for rounded finishes. Its design allows for machining all types of edges, including postforming and performing panels. Consult our technical team for more information.



Code	D Tool diameter (mm)	d Copier diameter (mm)	B Flange height (mm)	R Radius (mm)	F Hole (mm)	Z Number of teeth	Machine
2749	70	64	30	2	16	4	USIKRAFT
13626	70	65,8	12	1,5	16	4	NANXING
4948	70	66	12	1	16	4	GIBEN/NANXING
2717	70	66	12	2	16	4	GIBEN/NANXING
2467	77,63	70	23	2	HSK25	4	HOMAG/IMA
2705	77,63	70	23	2	HSK25	6	HOMAG
6959	70,57	65	20	2	16	4	HOMAG
4309	55,3	48	13,5	2	16	3	SCM
3996	55,7	47,9	27,5	1	16	4	SCM
2010	77,5	70,5	16	2	16	4	SCM
1227	67,53	63	22	2	16	6	BIESSE

BIESSE SCRAPER

Code	Cutting length dimensions (mm)			R (mm)
	L	W	T	
37922RV	12,7	12,7	3,2	1
35041RV	12,7	12,7	3,2	2
3402A0124RV	13	11	3	1
3402A0126RV	13	11	3	2

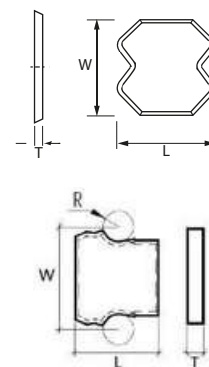

BIESSE MULTI-RADIUS SCRAPER

Code	Cutting length dimensions (mm)			R (mm)
	L	W	T	
101182	34	12,7	3	3-2-1,5
3402A0116RV	34	12,7	3	2-1,5-1

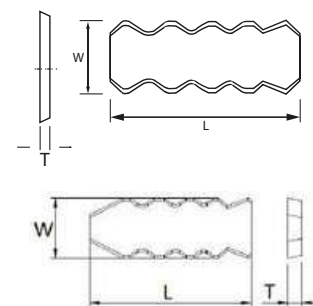

BIESSE MULTI-RADIUS INTERCHANGEABLE INSERT

Code	Cutting length dimensions (mm)			R (mm)
	L	W	T	
3402N0082DXRV	25	19,5	2	2-1,5-1
3402N0082SXR	25	19,5	2	2-1,5-1

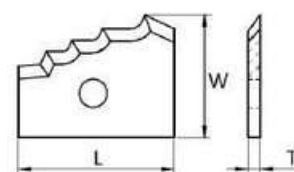

BIESSE TRIANGULAR SCRAPER

Code	Cutting length dimensions (mm)		
	L	W	T
45180RV	22,9	19,8	2,5

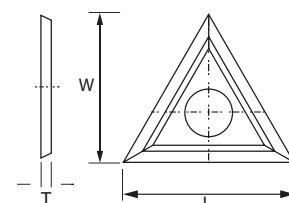

HOMAG EDGE BANDING SCRAPER

Code	Cutting length dimensions (mm)			R (mm)
	L	W	T	
32984RV	20	12	2	1
16419RV	20	12	2	2
16420RV	20	12	2	3

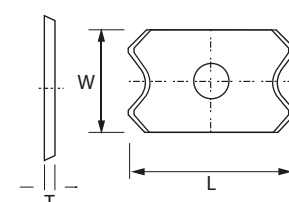

SPECIAL PROJECTS

As one of the leading references in manufacturing tools for woodworking, sheet materials, and other non-ferrous materials, Wirutex Brazil has become an expert in developing, designing, and manufacturing specific solutions.

With an Engineering department composed of specialists, Wirutex has developed over 15,000 special projects for its clients in more than 25 years of operation.

Trust your company's needs to Wirutex's technicians, who will provide specialized technical consulting and post-sale support, ensuring optimal performance and increased productivity for your business.



Check out examples of special projects below:



Finger Joint Cutter



Mortise Cutters



Robots and Long Holders



Custom Projects Based on Client Needs



Doors | Cabinet Door Profile



Doors | Frame - Jamb



Doors | Lock



Molding Machine



Male and Female Components

SHARPENING

To make the most of your **Wirutex Brazil** tool, follow the recommendations and care instructions below:



Handle it with care, follow the technical recommendations, and monitor the processes.



When handling the **Wirutex Brazil** diamond tool, avoid unnecessary shocks or impacts with other materials or surfaces, as this can damage the inserts.

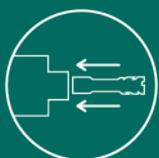

Before operation, ensure that the shank of the **Wirutex Brazil** tool is fully seated in the chuck.



In case of excessive vibration, stop the machine, remove the **Wirutex Brazil** tool, and take it to a qualified professional to check for eccentricity and the locking system.



Always adhere to the cutting parameters (feed rate and rotation) recommended by **Wirutex Brazil**.



We recommend that at the end of the workday, use WD40 or a similar product to prevent resin and dust from clogging the drainage channels of the **Wirutex Brazil** tool.

CHECK OUT THE WIRUTEX
BRAZIL SHARPENING
PROCESS VIDEO:



To ensure the durability of your Diamond Tool (PCD), Wirutex Brazil offers **100% Factory Sharpening**, a meticulous and technological process that guarantees the longest lifespan and return on your investment.

When a Diamond Tool arrives at your industrial facility, Wirutex specialists conduct a thorough assessment to determine the repair and recovery needs of the tool.

After this initial process, the tool is sent for cleaning and necessary operations, such as insert replacement, body recovery, and precision balancing. Finally, the tool undergoes a high-tech sharpening process using imported and automated machinery that operates 24 hours a day, 7 days a week.

Learn more about Wirutex's 100% Factory Sharpening:



Signs that it is time to sharpen your tool:

- Loss of finishing quality
- Increased machining effort
- Small serrations on the tool's teeth

Trust the sharpening of your diamond tools to a company with over **25 years of experience and cutting-edge factory technology**, ensuring greater safety and extending the life of your tool.

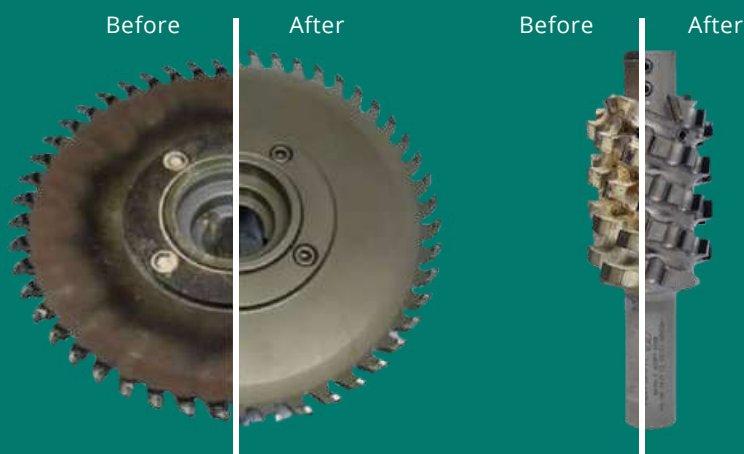



www.wirutex.com.br
available in English version



@bassowirutex.exp

exportacao@wirutex.com.br | +55 54 99200-5275

Rua Carlos Dreher Neto, 864 - Vila Nova
Bento Gonçalves - RS - Brasil - ZipCode: 95706-058